

Made in the US since 1941

# HOOD/LINER INSTALLATION

PARTS INCLUDED IN PACKAGE | SHAPES & SIZES VARY BY

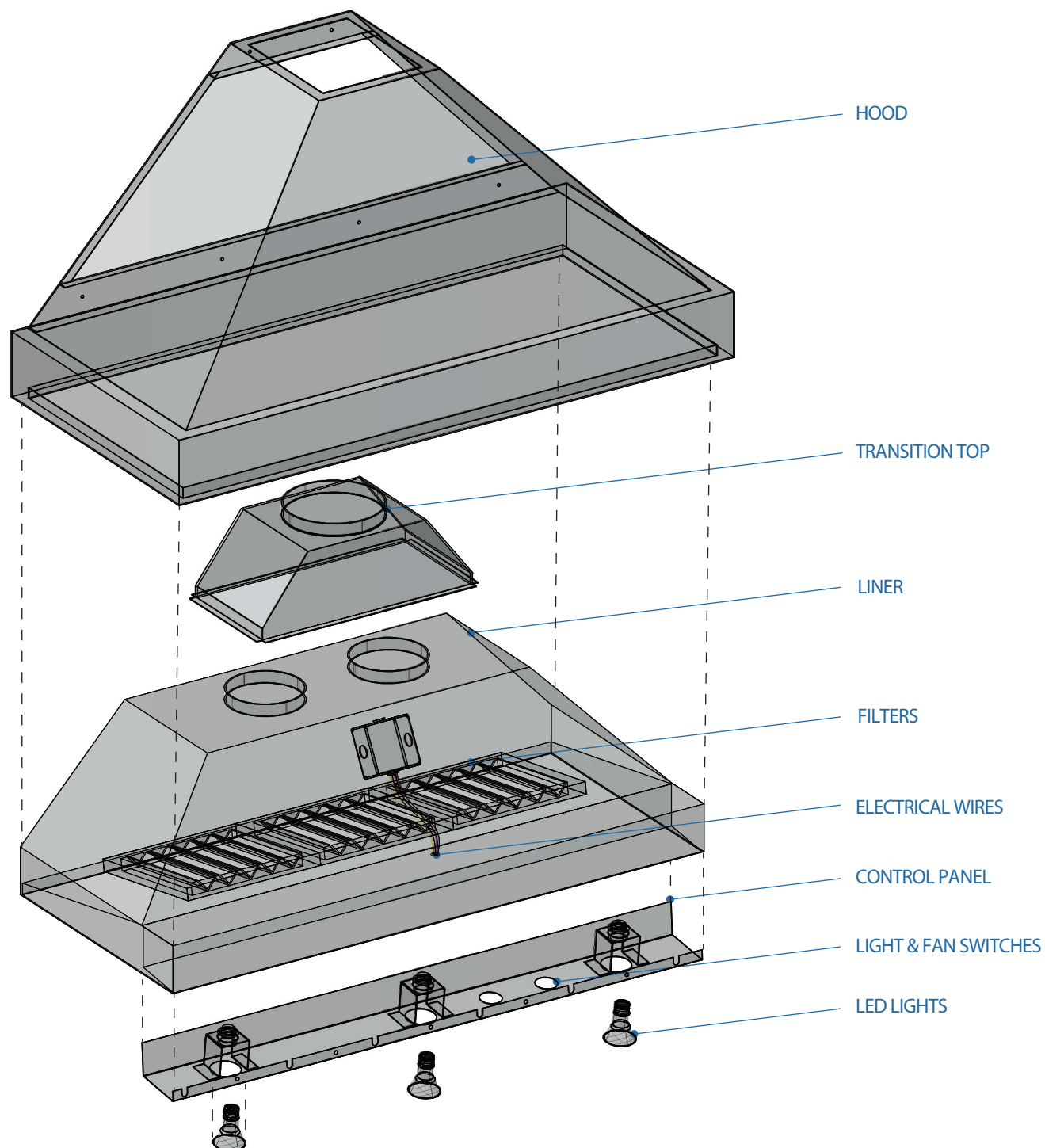

Performance Through Stainless!

43 South Linden Ave South San Francisco CA 94080 Ph (650) 589-4231 Fax (650) 589-3981 [www.berlinusa.com](http://www.berlinusa.com)

# HOOD & LINER INSTALLATION

## INSTALLATION INSTRUCTIONS

### DIRECTIONS FOR INSTALLATION

1. Position the hood liner on counter below the hood.
2. Unscrew and remove LED lights.
3. Reach into each of the light cut out holes and unscrew the metal screws that fasten the control panel to the liner. Refer to picture below.
4. Remove the light and control panel.
5. Feed conduit from ventilator into the Ventilator Switch cut out and connect the corresponding connector\*.
- [This only applies to remote or attic ventilators.]
6. Feed conduit\* from control panel into the power cut out and secure with the corresponding connector.
7. Remove filters from the liner for an easier connection between the transition top to the suspended duct work.
8. Lift the liner into the hood, reaching up through the exhaust outlet to the transition top, and guide the liner into place. Re-secure the liner with the sheet metal screws.
9. Lift the Control Panel up to the liner and connect the wires\* by color. Then secure the light panel to the wall with screws removed in Step 3. [For wall-mount hoods, secure Screw Covering Panel.]
10. Reach inside to where the transition top meets the ductwork and tape the joint, running strips of metal foil tape vertically.

\*Please refer to Electrical Diagram on the next page for more information.

\*\*This is a diagram of a basic hood. All products are custom designed. Shapes and sizes will vary.

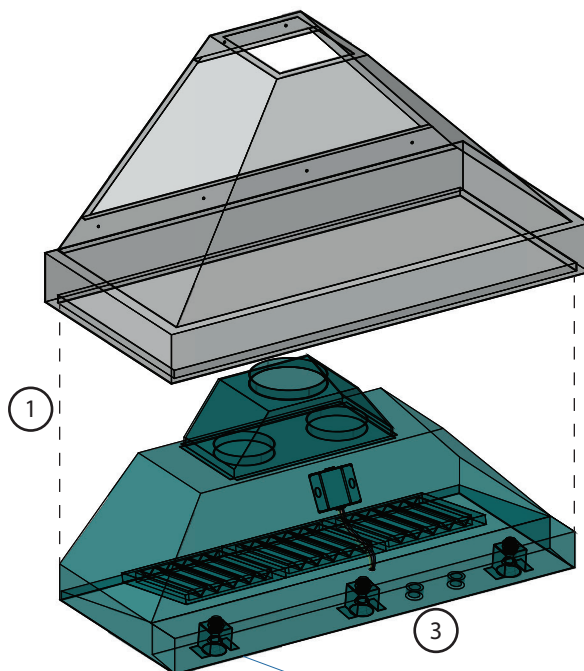

### REACH INTO LED SOCKET FIND SCREW

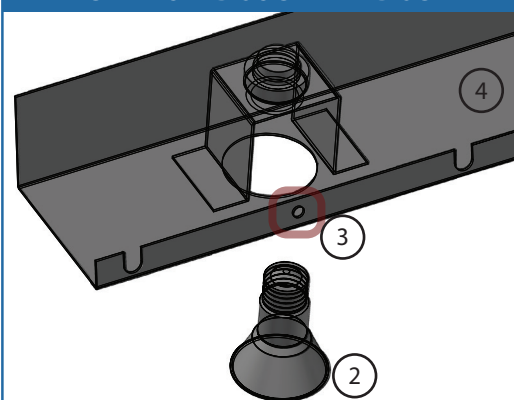

### CONNECT POWER AND VENTILATOR WIRES

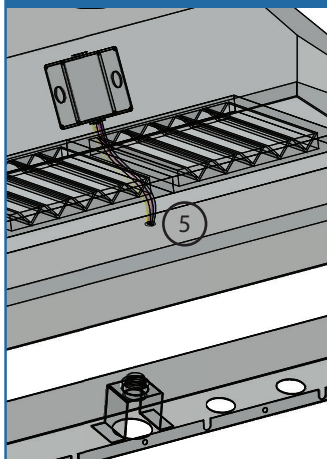

### SAMPLE PHOTO



### SAMPLE PHOTO



# HOOD & LINER INSTALLATION

## ELECTRICAL WIRING DIAGRAM | FINISHED VIEWS

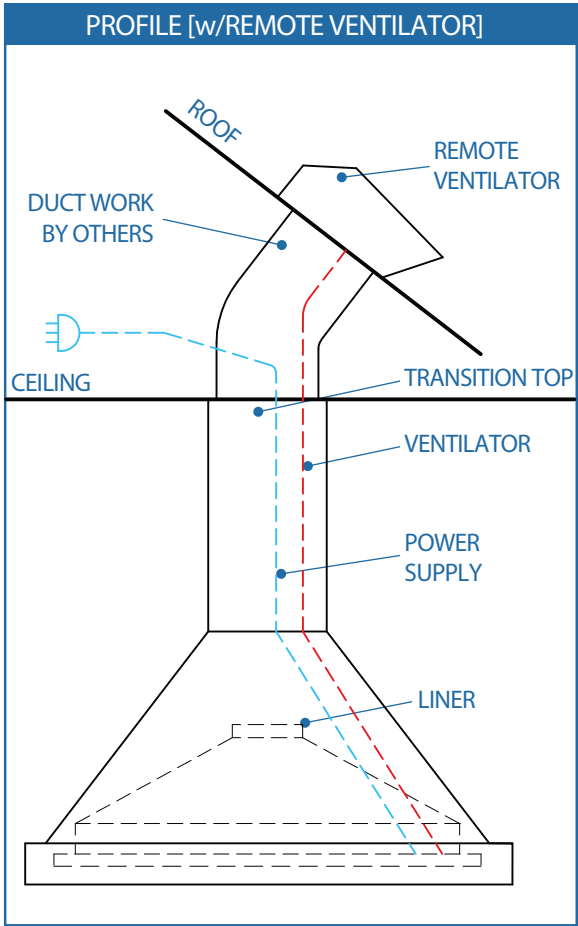
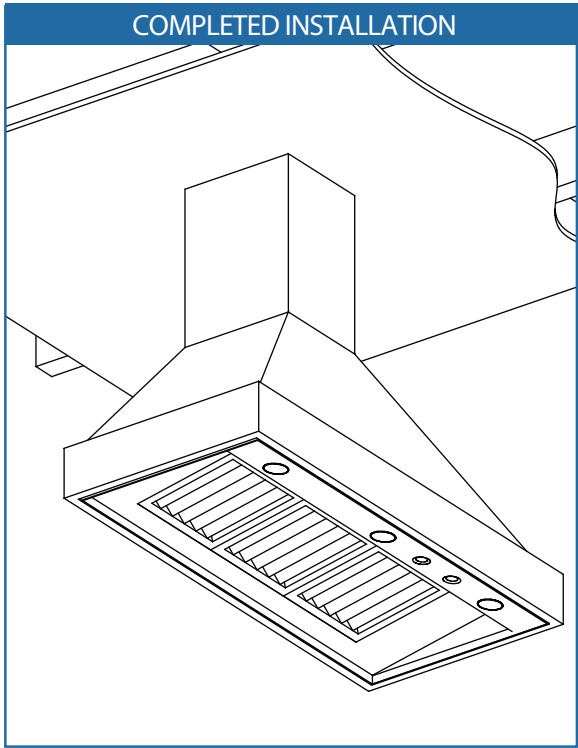
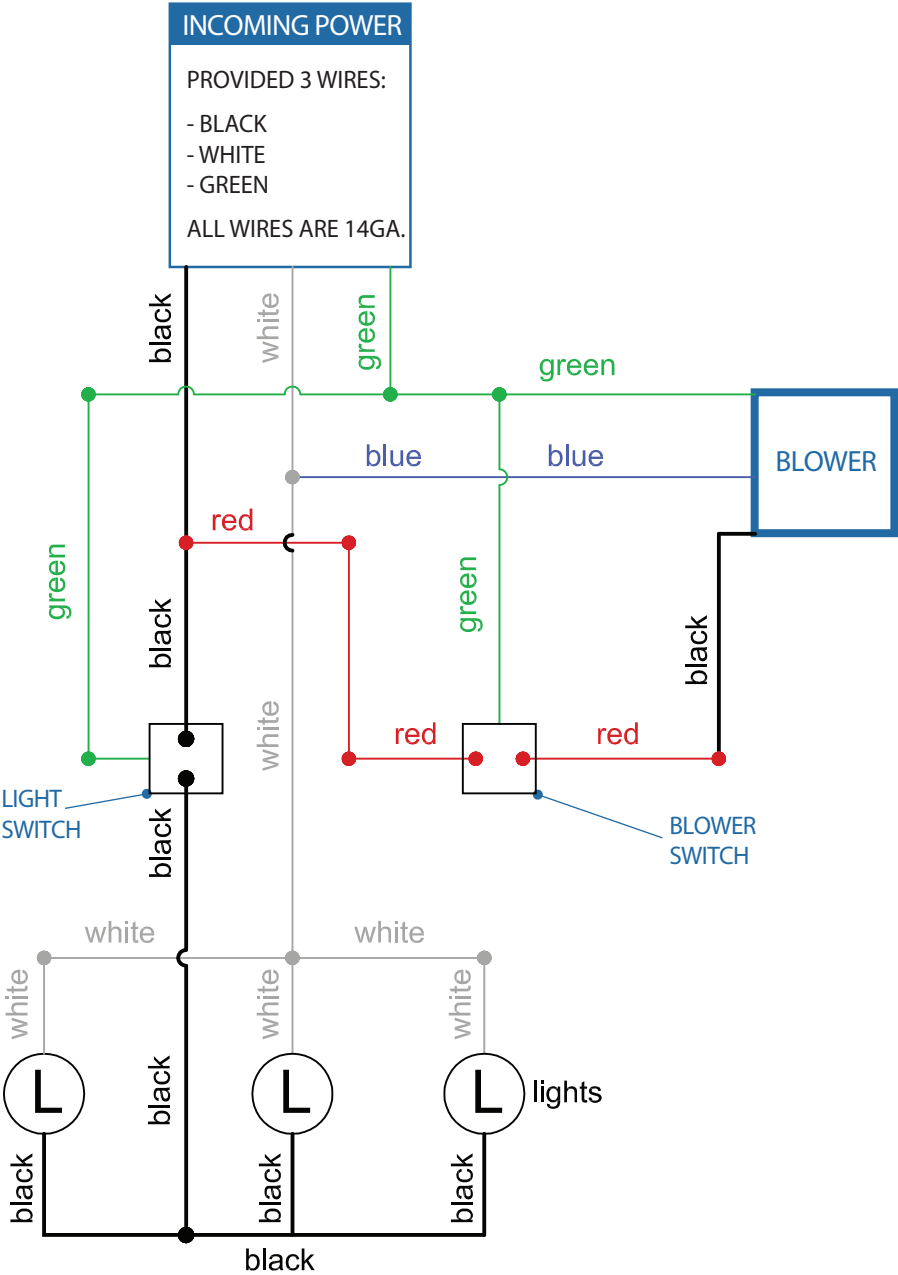

Made in the US since 1941

# HOOD & LINER INSTALLATION

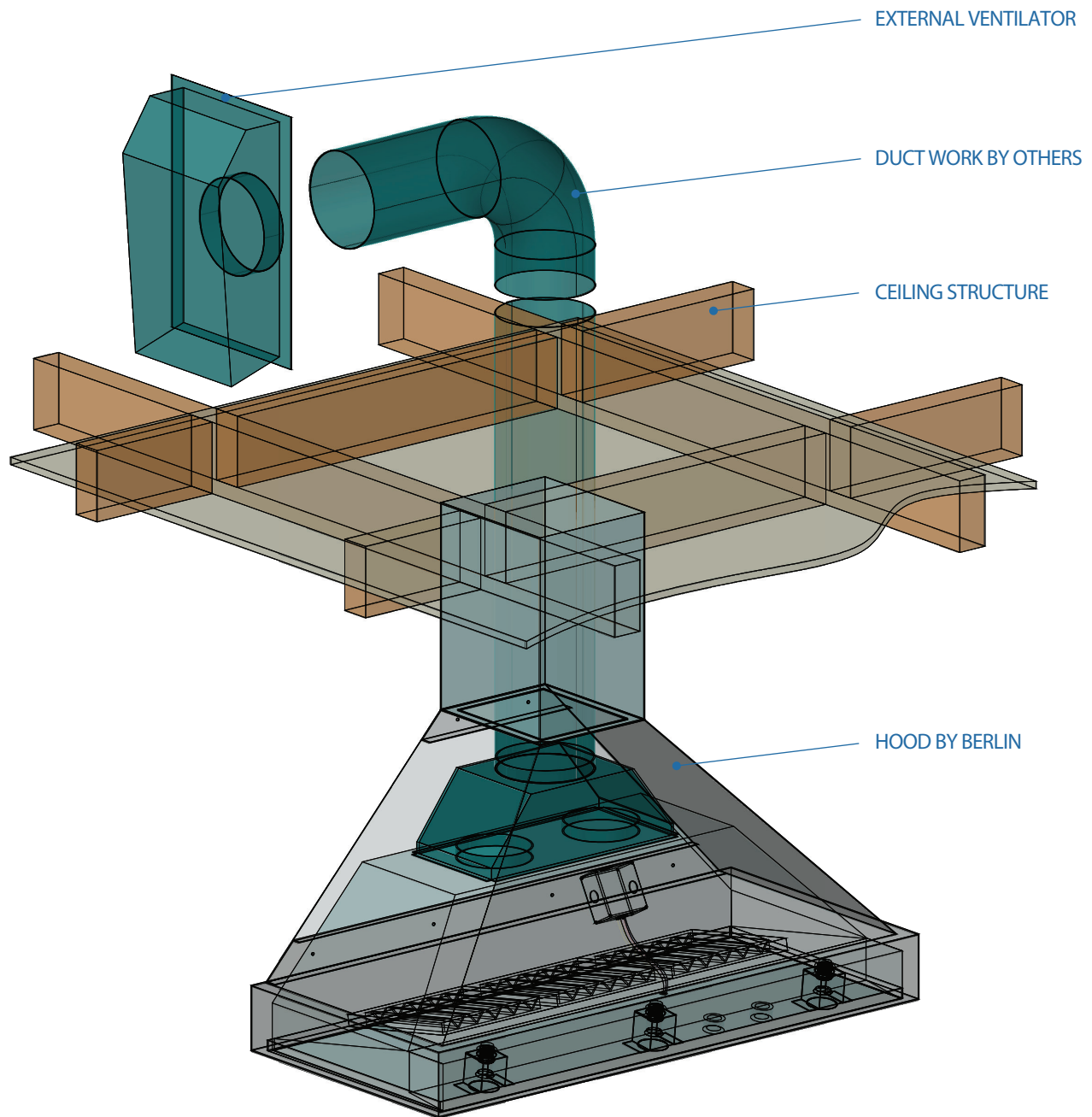

Performance Through Stainless!

43 South Linden Ave South San Francisco CA 94080 Ph (650) 589-4231 Fax (650) 589-3981 [www.berlinusa.com](http://www.berlinusa.com)